

Substrate Specification Sheet 7

Armourcoat QA Working Specification Applying Polished Plaster to MDF Panels

1 Introduction

Polished Plaster adheres well to MDF as can be seen from the samples we send out. It will give an amazing finish to fixtures and fittings constructed from MDF but there are **strict guidelines** for design and construction that **must** be adhered to.

Plastering over a junction between MDF panels will almost inevitably result in cracking. We have experimented extensively with many different grades of MDF and many different construction methods but have never successfully overcome this problem long term. **MDF always shrinks.**

The only way we recommend using Polished Plaster to coat an MDF structure is as follows:

2 Detailing of MDF Panels

The polished plaster cannot form a continuous surface over a join between panels without the likelihood of a crack forming. The design must therefore avoid this detailing by either using panels without joins or by machining a rebate at any junction. See Figures 1 to 4 overleaf. This rebate ensures that the polished plaster does not bridge a join between panels and can be painted in a colour to match the polished plaster or filled with mastic. The use of mastic can add to the impression that the panels are made from stone. While a crack is likely to form in a painted rebate, the shadow formed in the rebate will de-emphasise the crack.

Avoid fixing through the face of the MDF wherever possible. MDF shrinks in thickness slightly and this can cause the filler over fixings to protrude slightly several months after completion. Don't whatever you do use a water based filler on countersinks as this causes them to swell making this problem worse. Using a good quality moisture resistant MDF such as is made by Medite minimises these problems.

3 Preparation of MDF

- Ensure that the MDF is totally dry to avoid shrinkage or de-lamination problems
- Fill any holes or countersinks in panels with 2 pack polyester wood filler (avoid face fixing).
- Any corners to be plastered need to be blunted to roughly 2 mm radius with sandpaper. **We will not apply polished plaster to rebate edges.**

Apply 2 coats of Albany All Purpose Primer, or equivalent oil-based wood primer, to all 6 sides of the MDF panels and allow cure time of at least 72 hours (3 days) minimum, to ensure that the MDF is completely sealed. If water from the polished plaster penetrates into the MDF, it will cause it to swell and warp. Lightly sand the surface of the face to be plastered and apply 1 coat of Armourcoat K40 Primer. Allow the K40 Primer to dry completely before applying the various Armourcoat finishes. All MDF panels must be at least 18 mm thick.

4 Finishing the Rebates

The edges of the polished plaster will reveal the backing coats (off white) as can be seen on the Armourcoat samples. To cover these edges, the rebates should be finally treated after the polished plaster has been applied.

Once the polished plaster application has been completed, mask the edges of the polished plaster and clean the rebates with sandpaper to achieve a crisp edge.

4.1 Paint on top coats to rebates using **water-based** paint or use mastic as described in section 2.

4.2 Mastic rebates using water based, oil free mastic such as acrylic decorators filler / caulk. Oil based paint or mastic can soak into the edge of the polished plaster and cause staining.

5 Additional Literature

DOCUMENT	REF
Full Set of Building Substrate Specification Sheets are available. (See web site)	
Plasterboard/Drylining Installation and Finishing	SSS1
Plasterboard/Drylining with AntiCrack Substrates	SSS2
Plaster on Brick, Block or Concrete Substrates	SSS3
Glasroc and GRG Substrates	SSS4
Previously Decorated Substrates	SSS5
Sand/Cement Substrates	SSS6
MDF Substrates	SSS7
Duturo Backgrounds and Application	SSS8
Bluclad Board Substrates	SSS9
Exterior Application	SSS10

Whilst every attempt has been made to ensure the accuracy and reliability of the information contained in this document, the information should not be relied upon as a substitute for formal advice. Armourcoat Ltd, its employees and agents will not be liable for any loss or damage, of any kind, arising out of or in connection with the use of this document. Please refer to the company disclaimer for further details.

JOINING MDF PANELS – to accompany SSS7

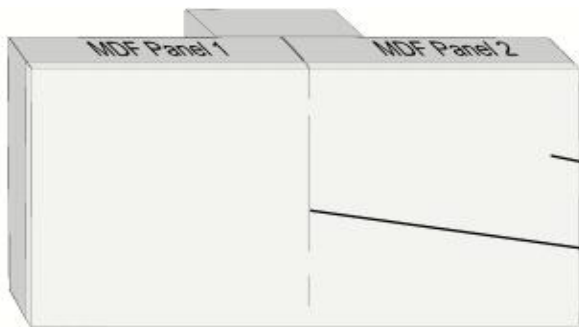

CONSTRUCTION METHOD LIKELY TO RESULT WITH CRACKING FIGURE1

Polished plaster
Even with good support behind the join between the MDF panels, cracking is likely to take place here.

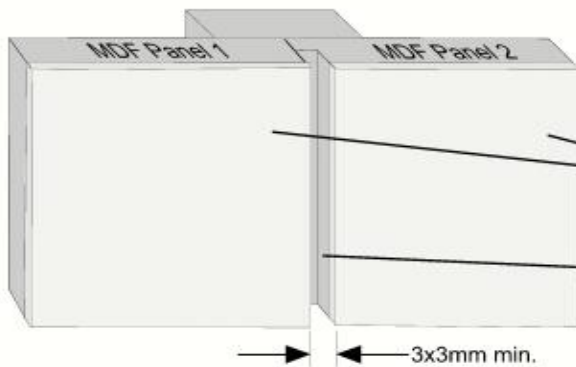

CONSTRUCTION METHOD NECESSARY TO OVERCOME CRACKING FIGURE2

Polished plaster
Polished plaster must not bridge the rebate. Rebate may be painted or filled with mastic according to Armourcoat specification - see notes.

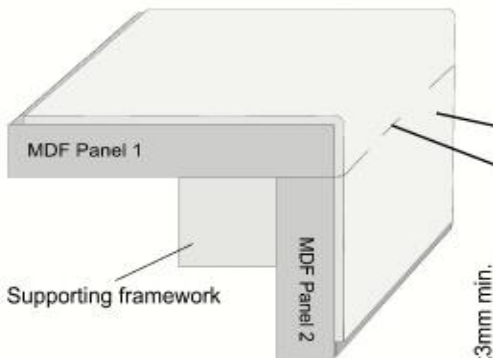

CONSTRUCTION METHOD LIKELY TO RESULT WITH CRACKING FIGURE3

Polished plaster
Even with good support behind the join between the MDF panels, cracking is likely to take place here.

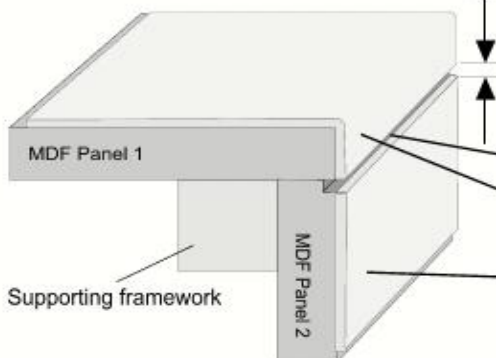

CONSTRUCTION METHOD NECESSARY TO OVERCOME CRACKING FIGURE4

Polished plaster
Polished plaster must not bridge the rebate. Rebate may be painted or filled with mastic according to Armourcoat specification - see notes.

spec7-7/6/99

Armourcoat Limited
Morewood Close London Road
Sevenoaks Kent TN13 2HU United Kingdom
Tel: +44 (0)1732 460 668 Fax +44 (0)1732 450 930
Email: technical@armourcoat.co.uk
web: www.armourcoat.com

Detailing Sheet DS7

Detailing for Armourcoat finishes on MDF substrates

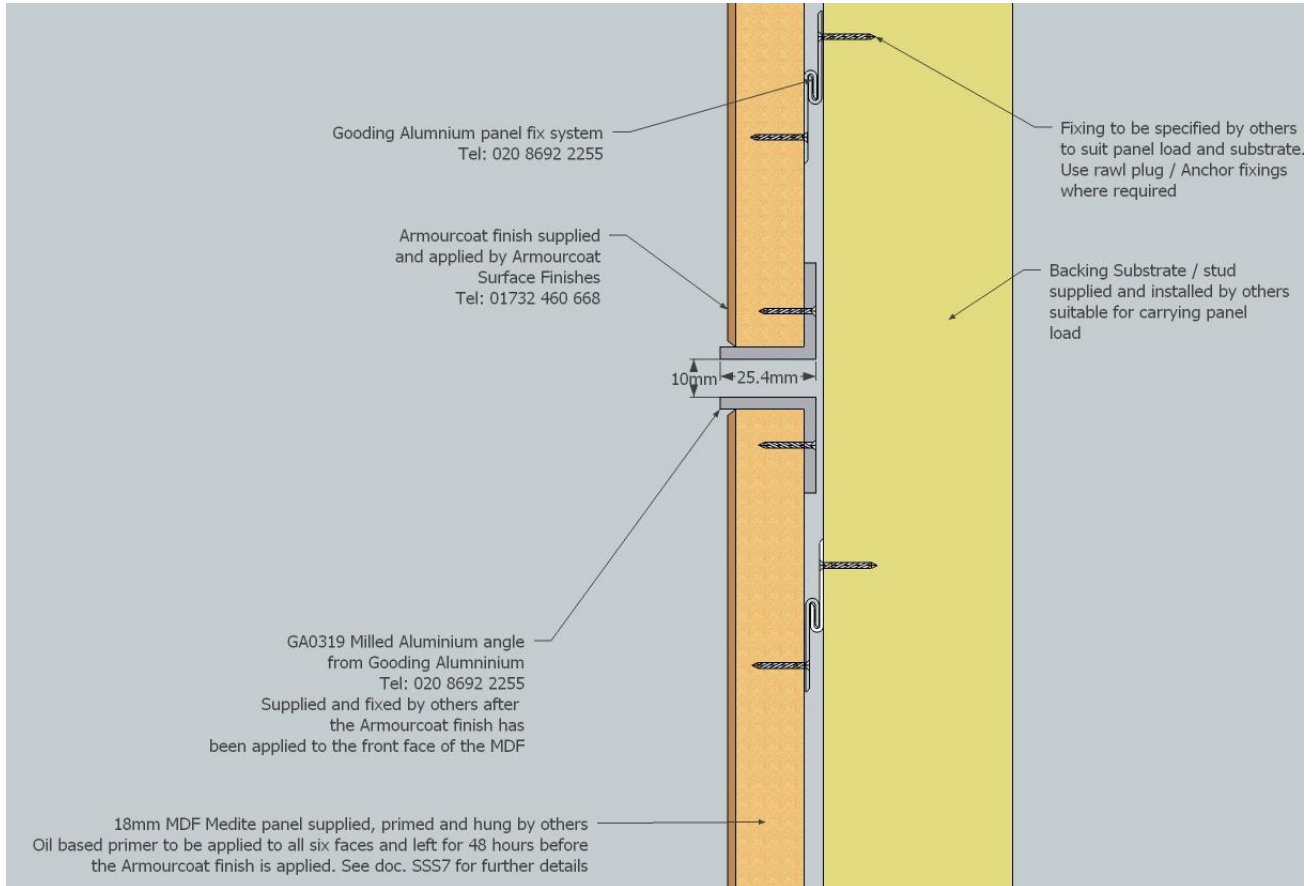

MDF protected panel edge detail

The specification is for guidance only. It describes good working practice. It does not claim to be the right or only method of using MDF to provide a solid substrate and is made without responsibility for the execution of the work. Build quality is the responsibility of the installer/builder. Please read this specification sheet in tandem with specification sheet number seven – "Armourcoat QA Working Specification Applying Polished Plaster to MDF Panels".

Whilst every attempt has been made to ensure the accuracy and reliability of the information contained in this document, the information should not be relied upon as a substitute for formal advice. Armourcoat Ltd, its employees and agents will not be liable for any loss or damage, of any kind, arising out of or in connection with the use of this document. Please refer to the company disclaimer for further details.

SPD DS7 0211©

Armourcoat Limited
Morewood Close London Road
Sevenoaks Kent TN13 2HU United Kingdom
Tel: +44 (0)1732 460 668 Fax +44 (0)1732 450 930
Email: technical@armourcoat.co.uk

web: www.armourcoat.com