

## Detailing Sheet DS3

### Detailing for Armourcoat finishes on brick / block / concrete substrates

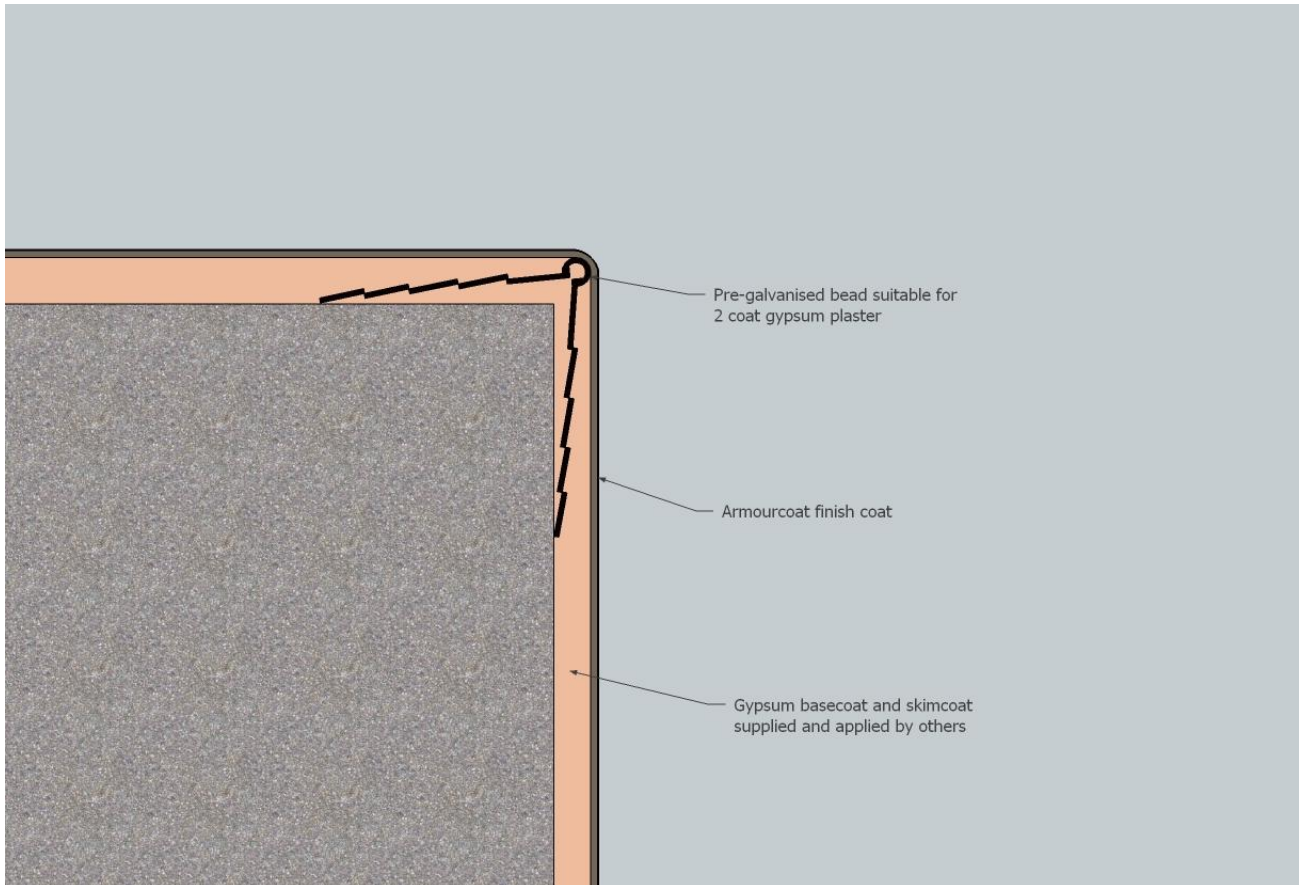

### 90 degree corner detail

The specification is for guidance only. It describes good working practice. It does not claim to be the right or only method to provide a solid substrate and is made without responsibility for the execution of the work. Build quality is the responsibility of the installer/builder. Please read this specification sheet in tandem with specification sheet number three – “Armourcoat (ASF) QA Working Specification for Brick/Block/Concrete Substrates”. Detail drawings are not to scale – DO NOT SCALE.

Whilst every attempt has been made to ensure the accuracy and reliability of the information contained in this document, the information should not be relied upon as a substitute for formal advice. Armourcoat Ltd, its employees and agents will not be liable for any loss or damage, of any kind, arising out of or in connection with the use of this document. Please refer to the company disclaimer for further details.

SPD DS3 1209©

#### Armourcoat Limited

Morewood Close London Road  
Sevenoaks Kent TN13 2HU United Kingdom  
Tel: +44 (0)1732 460 668 Fax +44 (0)1732 450 930  
Email: [technical@armourcoat.co.uk](mailto:technical@armourcoat.co.uk)

web: [www.armourcoat.com](http://www.armourcoat.com)

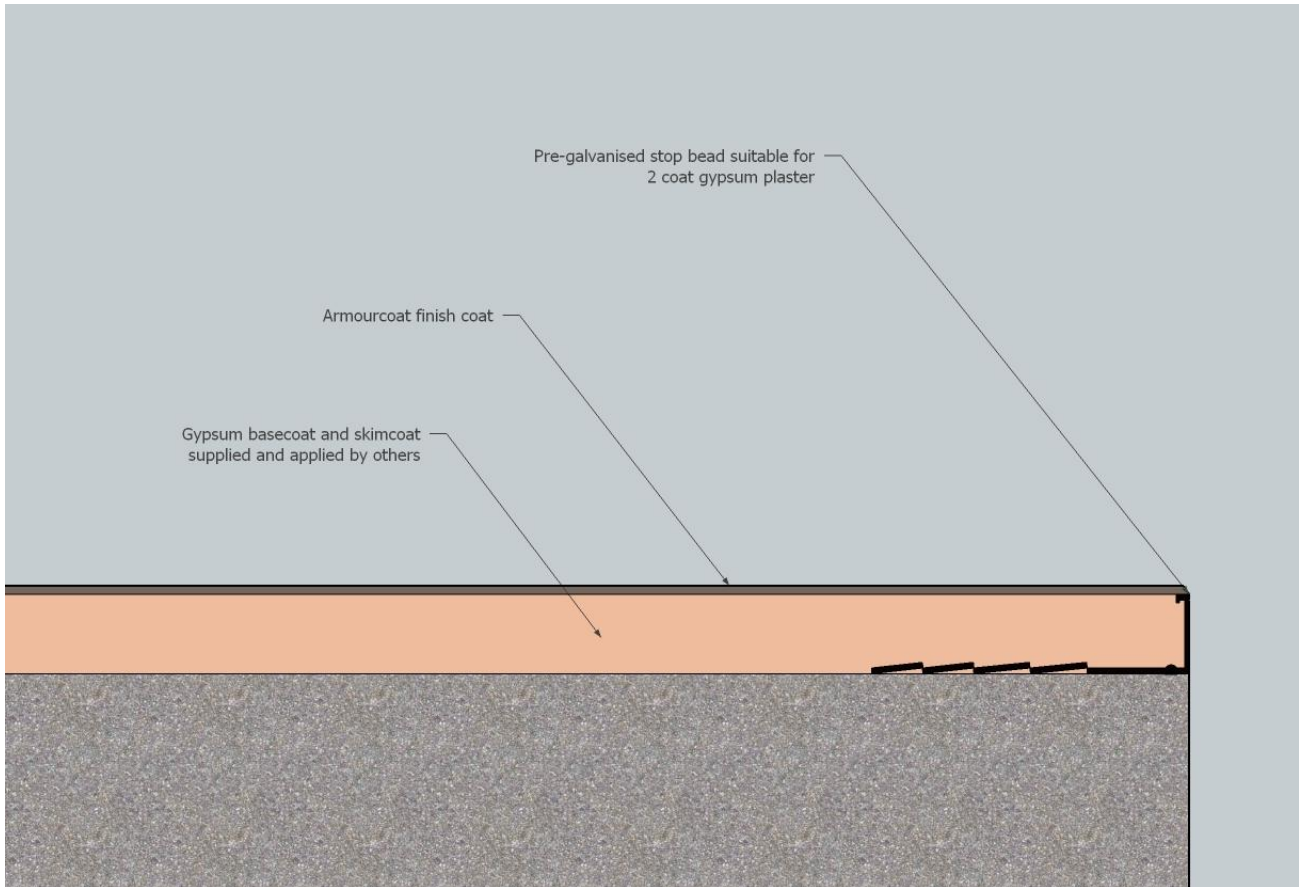

## Stop bead detail

The specification is for guidance only. It describes good working practice. It does not claim to be the right or only method to provide a solid substrate and is made without responsibility for the execution of the work. Build quality is the responsibility of the installer/builder. Please read this specification sheet in tandem with specification sheet number three – “Armourcoat (ASF) QA Working Specification for Brick/Block/Concrete Substrates”. Detail drawings are not to scale – DO NOT SCALE.

Whilst every attempt has been made to ensure the accuracy and reliability of the information contained in this document, the information should not be relied upon as a substitute for formal advice. Armourcoat Ltd, its employees and agents will not be liable for any loss or damage, of any kind, arising out of or in connection with the use of this document. Please refer to the company disclaimer for further details.

SPD DS3 1209©

**Armourcoat Limited**  
Morewood Close London Road  
Sevenoaks Kent TN13 2HU United Kingdom  
Tel: +44 (0)1732 460 668 Fax +44 (0)1732 450 930  
Email: [technical@armourcoat.co.uk](mailto:technical@armourcoat.co.uk)

web: [www.armourcoat.com](http://www.armourcoat.com)

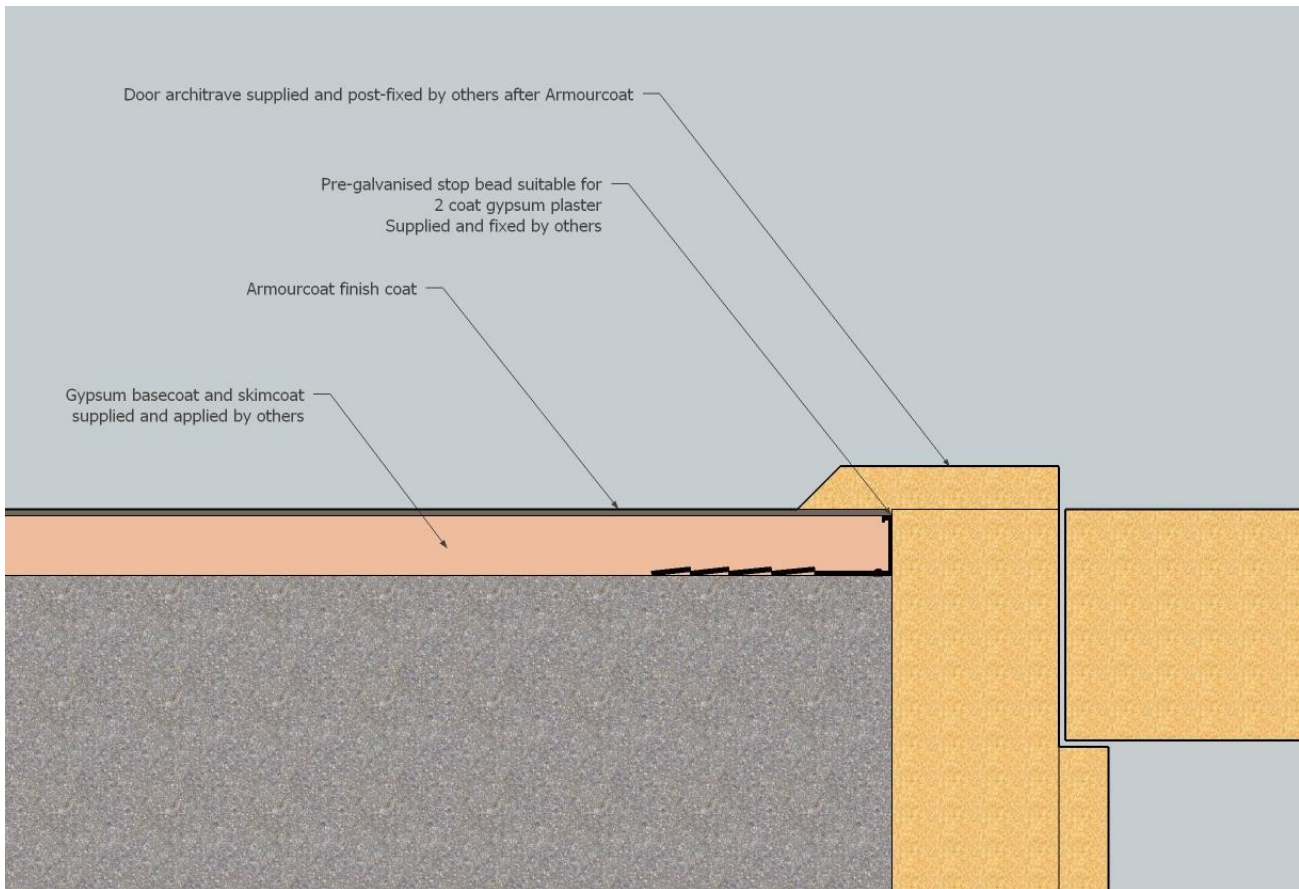

### Stop bead door junction detail

The specification is for guidance only. It describes good working practice. It does not claim to be the right or only method to provide a solid substrate and is made without responsibility for the execution of the work. Build quality is the responsibility of the installer/builder. Please read this specification sheet in tandem with specification sheet number three – “Armourcoat (ASF) QA Working Specification for Brick/Block/Concrete Substrates”. Detail drawings are not to scale – DO NOT SCALE.

Whilst every attempt has been made to ensure the accuracy and reliability of the information contained in this document, the information should not be relied upon as a substitute for formal advice. Armourcoat Ltd, its employees and agents will not be liable for any loss or damage, of any kind, arising out of or in connection with the use of this document. Please refer to the company disclaimer for further details.

SPD DS3 1209©

**Armourcoat Limited**  
Morewood Close London Road  
Sevenoaks Kent TN13 2HU United Kingdom  
Tel: +44 (0)1732 460 668 Fax +44 (0)1732 450 930  
Email: technical@armourcoat.co.uk

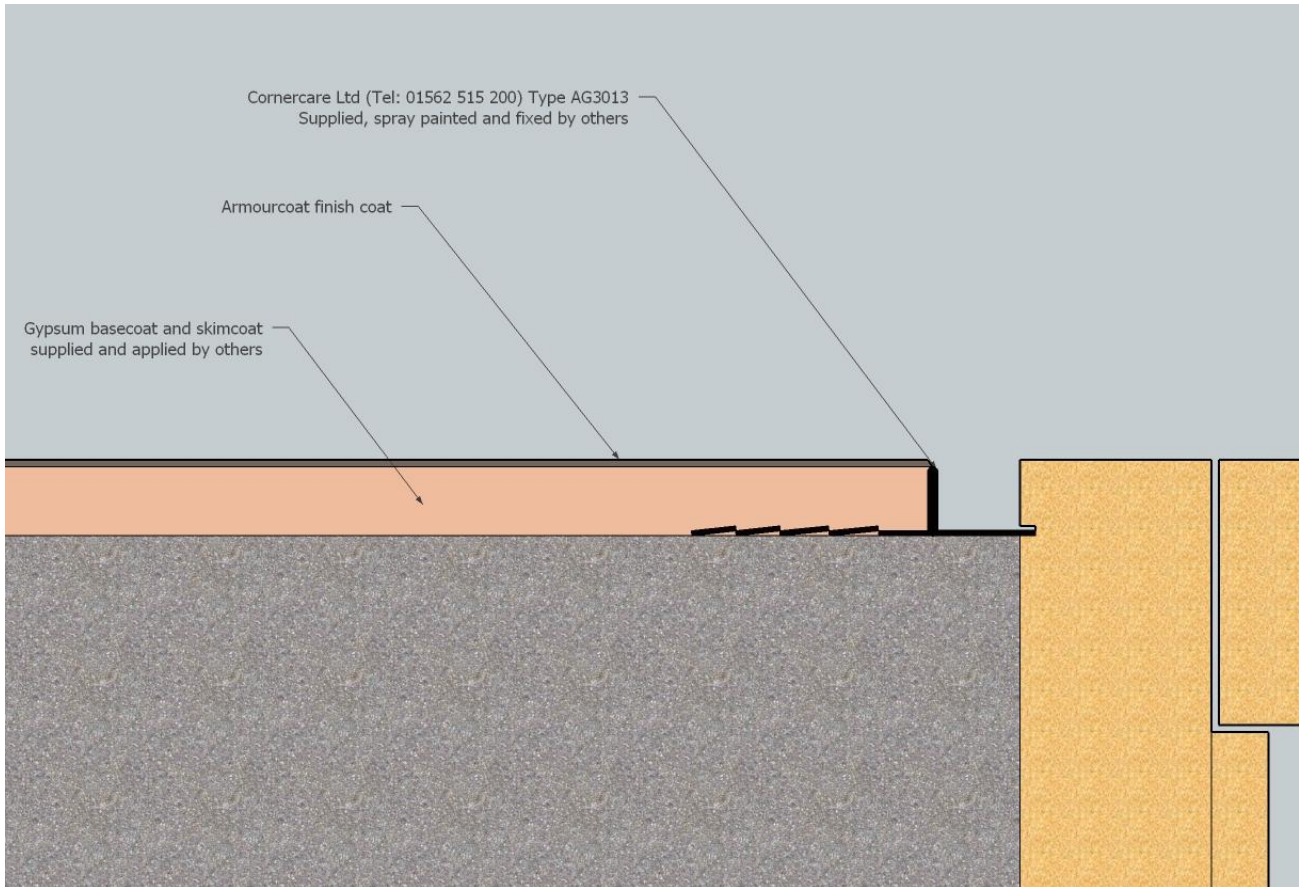

### Shadow gap door junction detail

The specification is for guidance only. It describes good working practice. It does not claim to be the right or only method to provide a solid substrate and is made without responsibility for the execution of the work. Build quality is the responsibility of the installer/builder. Please read this specification sheet in tandem with specification sheet number three – “Armourcoat (ASF) QA Working Specification for Brick/Block/Concrete Substrates”. Detail drawings are not to scale – DO NOT SCALE.

Whilst every attempt has been made to ensure the accuracy and reliability of the information contained in this document, the information should not be relied upon as a substitute for formal advice. Armourcoat Ltd, its employees and agents will not be liable for any loss or damage, of any kind, arising out of or in connection with the use of this document. Please refer to the company disclaimer for further details.

SPD DS3 1209©

**Armourcoat Limited**  
Morewood Close London Road  
Sevenoaks Kent TN13 2HU United Kingdom  
Tel: +44 (0)1732 460 668 Fax +44 (0)1732 450 930  
Email: technical@armourcoat.co.uk